

## Compliance

CE certificated post, compliant with standard UNI EN 40-5. 

## Description

Lamp post in UNI EN 1561 cast iron and UNI EN10219-1 steel, hot-galvanized to UNI EN ISO 1461 standards, composed as follows:

Tapered post (A) in steel with a circular cross-section, hot-galvanized, made up of two tubes welded together at their junction (B), with dimensions  $\varnothing 127 \times 3500$  mm;  $\varnothing 102 \times 1900$  mm. The post is designed to be attached to a foundation plinth (P) by means of a flange ( $\varnothing 266$  mm - thickness 18 mm). It is provided with an M10 earthing bolt marked by a small indicator plate, a slot (C - height 186 x 45 mm) for the installation of a class II insulation terminal board with or without fuse. The top of the post has six M10 screws (Z) for securing a suspension bracket fitted into the post.

1° Cast iron base height 1100 mm (diam. 400 mm), cast in a single piece with a circular plinth surmounted by a torus (D); a cylindrical central section with an inspection hatch (110 x 350 mm), a torus (E) and a cylindrical section decorated with a torus to form a junction for the steel post.

2° cast iron decorative ring, to be fitted where the post is tapered. Shapes and measurements as indicated in the drawing.

The total height is 5400 mm.

Total weight is 138 Kg.

## Protection of surfaces

Please refer to the specification on painting procedures of the materials.

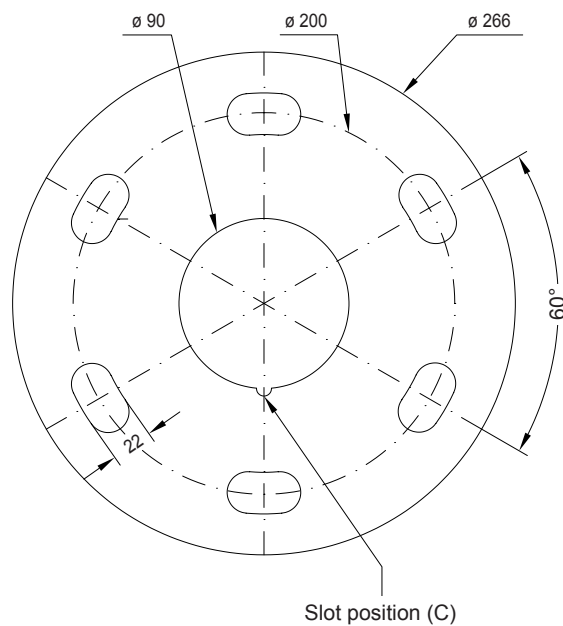

Flange plan  
Scale 1:4

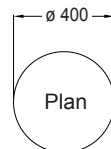
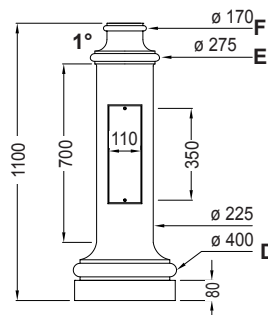

Exploded

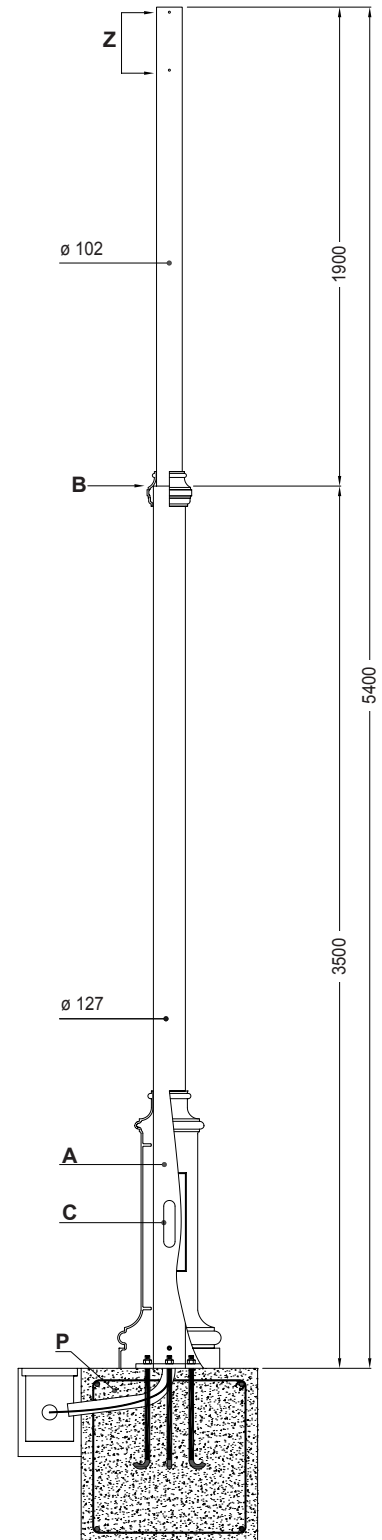

Section

**NB:** The measurements are in millimeters.

**Neri S.p.A. Property** - Any reproduction and use for its own purposes is forbidden.