

DESCRIPTION

Compliance

- Conforme alle norme EN 60598-1; EN 60598-2-3; EN 62031;
EN55015 EMC; EN 61000-3-2/3; EN 62471; EN 62493



Dimensions - Area - Weight

| Height | Width | Length | Area exposed to wind (S) | Weight |
|--------|-------|--------|--------------------------|--------|
| 242mm | 420mm | - | 0,062 m ² | 8,6kg |

Electrical characteristics

| Voltage | Frequency | Rating IP | Isolation class | Cos φ | Operative Temp. |
|---------|-----------|-----------|-----------------|-------|-----------------|
| 230V | 50 Hz | 66 | CL II □ | > 0,9 | -35°C...+40°C |

Connection

- Quick coupling in brass with threaded tube G 3/4" (ISO228/1-BSP/G).
- Suitable for suspended installation

Materials

- Aluminium casting.
- Transparent extra-clear flat glass. IK09 shock resistant.
- Stainless steel and brass fasteners.

Structure - Main components

- Upper frame made in aluminium casting, opening with tilting hinge via two hiddenscrews and automatic switch.
- Quick coupling threaded G 3/4" for fixing to support and PG16 cable seal.
- Bottom frame made in aluminium casting, opening via two hiddenscrews for access to the wiring and optical compartment.
- LED module and wiring plate easily removable.
- Gasket in silicone between the upper and bottom frames.

Electrical auxiliaries

- Terminals for wires with a max. section of 2,5 mm².
- Automatic disconnecter.

Operations and maintenance

- To access the optical and wiring compartment, loosen the two screws, rotate and lower the bottom frame. The bottom frame remains suspended by the safety cable.
- During installation, follow the instructions for the correct orientation on the support.
- Wiring with fully replaceable parts (Module, LED, Driver).
- Periodic maintenance (about once a year) for external cleaning of the structure and screen from dust and smog, and the control of fastening of all screws, must be performed with light fixture switched off and cold.

Painting

- Upper frame: Standard color is dark gray, type Neri.
- Bottom frame: White RAL 9016.
- Information about paint steps used on this product in specific technical sheet.

Code construction

- To create the complete code of the configuration, insert sequential parts of the code on the configuration of the optics (XX), LED modules (YYY) and functions of the power supply (ZZ). Example: **SN103L 19 3C1 14**.
- Classe I of insulation (in this case the product code is to be requested).

DRAWINGS AND TECHNICAL INFORMATIONS

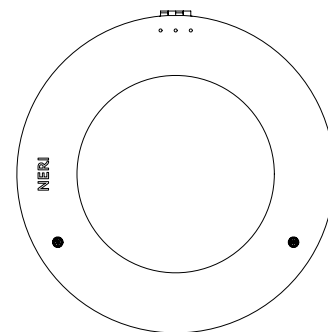
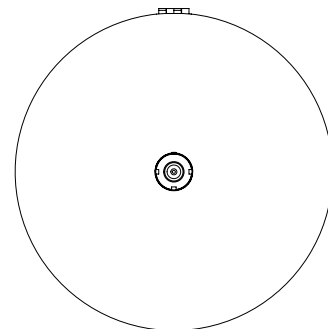
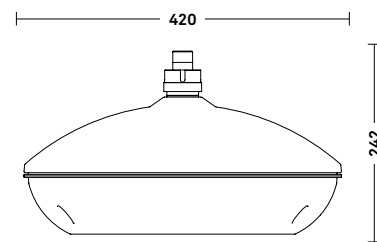

DESCRIPTION

Screens

| Cod. SSS | Light fixture series | Material | Finiture | Shock R. |
|----------|----------------------|---------------------|------------|----------|
| A21 | 103 | Tempered flat glass | Trasparent | IK08 |

Optics

| Cod. X | Reflector mod. | Lighting classes | IES Class |
|--------|-------------------------|----------------------------|--------------|
| 1 | mod. 1 - Fixed position | Illuminazione stradale | Full cut-off |
| 9 | mod. 9 - Fixed position | Ciclopedonale e aree miste | Full cut-off |

- Reflector in sheet aluminum, polished and oxidized. (thickness 1 mm, purity 99.90%).
- Lampholder regulable for a optimal positioning of lamp.
- Minimum installation height: 2.75 meters.
- Maximum installation height: over 15 meters.

Cablaggio (Predisposizione per lampade con ottica e portalamпада)

| Cod. YY | Lamps predisposition | W | Optics | Lampholders |
|---------|--------------------------------------|-----|--------|-------------|
| 32 | (MT) Metal halide - (ST) Sodium H.P. | 70 | 1 9 | E27 |
| 33 | (MT) Metal halide - (ST) Sodium H.P. | 100 | 1 9 | E40 |
| 35 | (MT) Metal halide - (ST) Sodium H.P. | 150 | 1 9 | E40 |

- Compact electromagnetic ballast with high efficiency (CELMA class EEI=A3), with thermal protection, electronic ignitor (pulses until to 4.5 KV) and power factor correction capacitor.
- Ceramic lamp holders in relation to the type of lamp.
- Electric components on wiring plate easily removable.
- Wiring with plug-in connections on plate easily removable.
- Terminal board for cables with max section of 2,5 mm².

Electromagnetic wirings (characteristics)

| Cod. ZZ | Description |
|---------|--|
| 04 | CL II (insulation class) - Fuse 250V-T6.3A (5 x 20 mm) |

Note

- Use lamps with efficiency ≥ 90 lm/W.
- The lamps are not included in the wiring.
- On request can be realized other wiring configurations.

PHOTOMETRIC CURVES

Optic mod. 01 (type III)

Roadways - Side road installation

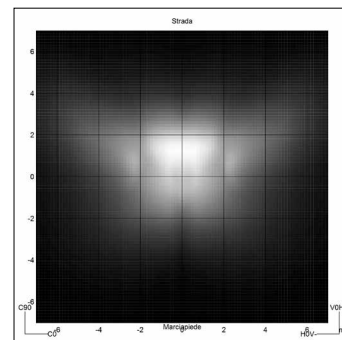
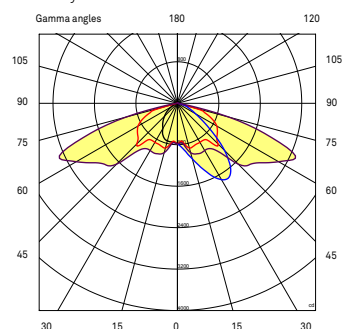

Optic mod. 09 (type II)

Roadways - Center road installation

