

Description

Lamp-post made of S235J UNI EN 10219 steel sheet, with longitudinal de-seamed welding, hot-galvanized in compliance with standard UNI EN ISO 1461, all corresponding to drawing in terms of various shapes, measurements and mouldings.

The post comprises the following:

a conical curved steel section post (A - lower diam. 11.4 cm - upper diam. 6.0 cm), suitable for flange fixing (diam. 24.6 cm - thickness 1.5 cm) on a foundation plinth (P); the post is equipped with a M10 screw for grounding marked with a special plate, a slot (B - h. 13.2 x 3.8 cm) for assembling of shunt terminal boards, a hatch (C) for closing the slot (B). The top end is closed by a plastic plug (D).

1°) a bracket welded at the top end of the post, made of a curved steel tube (diam. 4.2 cm) with a 3/4" GAS junction (E) used for attaching of the light fixture and two plastic plugs (F).

The overall height of the post is 575 cm.

Protection of surfaces

Please refer to the specification on painting procedures of the materials.

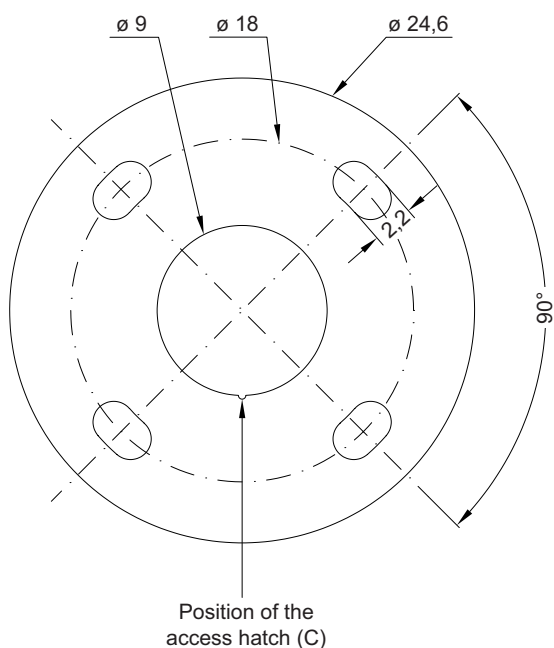

Flange plan
Scale 1:4

