

Compliance

CE certified post, compliant with standard UNI EN 40-5.



Description

Lamp-post in aluminium casting UNI EN 1706 and hot-galvanized steel S235J UNI EN 10025-2 conforming to standard UNI EN ISO 1461; all shapes, measurements and mouldings corresponding to drawing.

The post comprises the following:

Tapered post (A) made of circular section hot-galvanized steel, suitable for flange fixing (diam. 34.1 cm - thickness 2.0 cm) to a foundation plinth (P), comprising two tubes welded to each other in correspondence with taper (B), with the following dimensions: diam. cm 16.8 x 412 - diam. 12.7 x 556. It is supplied with an M10 screw for grounding marked by special plate, a slot (D - h. cm 18.6 x 4.5) with insulation class II terminal board with two fuses (mod. Conchiglia), a flush hatch (E) in aluminium die-casting for closing the slot (D) with IP 66 protection rating; two slots (C - h. 7.0 x 3.0 cm) set 180° apart for routing top section power cables.

1° elliptical aluminium casting base (cm 36 x 50), height cm. 81.5, made from two half-shells coupled to each other with four stainless steel screws. This system allows installation or removal even with the post already installed.

Each half-shell of the base has 3 elliptical slots at the bottom (G), closed with aluminium plates the same colour as the base (or optional decorative modules made of silk-effect polymethylmethacrylate available in green, blue or yellow);

2° cylindrical closure made of hot-galvanized steel casting, fastened with three M6 stainless steel dowels (F). Shapes and measurements as shown in drawing.

The overall height is cm 960.

Protection of surfaces

Please refer to the specification on painting procedures of the materials.

Accessoires

Optional decorative modules made of silk-effect polymethylmethacrylate:

cod. 0006.335.002 BLUE

cod. 0006.335.001 YELLOW

cod. 0006.335 GREEN

Consult specific sheets.

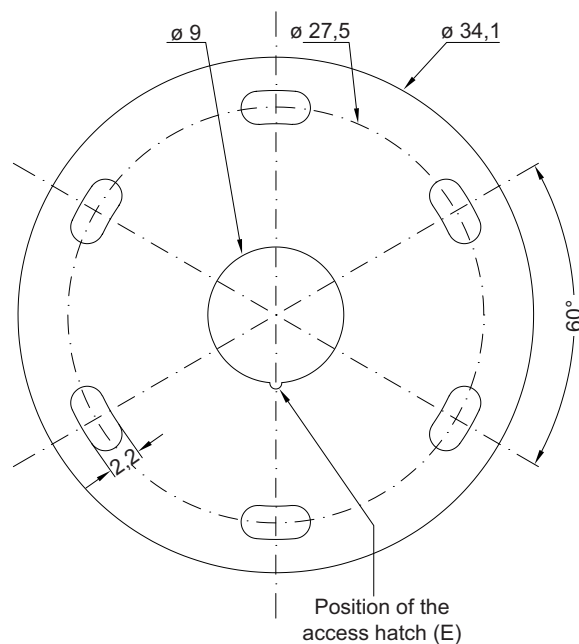
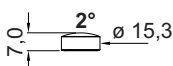

Flange plan
Scale 1:5

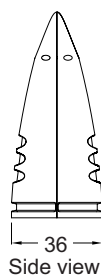

Side view

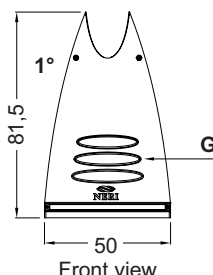

Front view

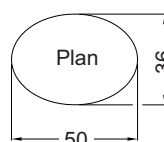

Plan

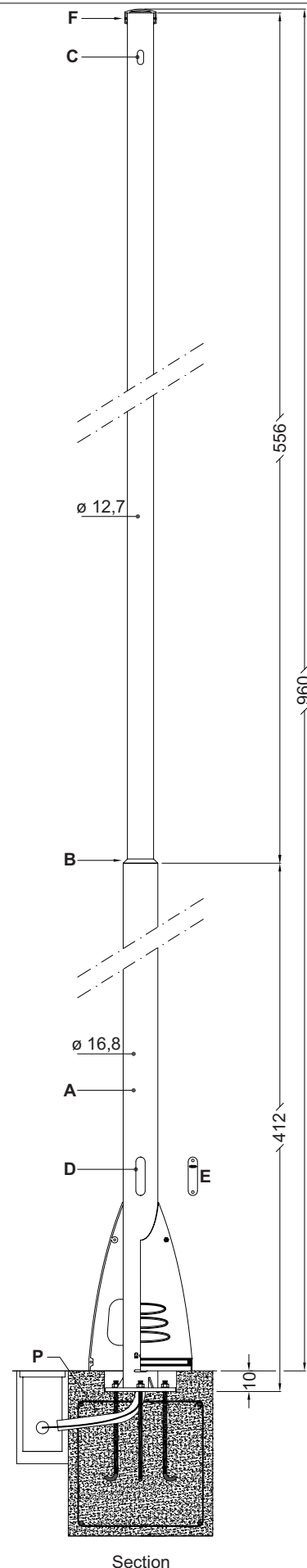

Section