

Use

Suitable support for suspended light fixtures.

Materials

Made in UNI EN 1561 cast iron, UNI EN 1563 nodular cast iron and S235J UNI EN 10219-1 steel, hot dip galvanized according to UNI EN ISO 1461.

Protection of surfaces

Please refer to the specification on painting procedures of the materials.

Dimensions and weight

Height 212 cm; width 93 cm.

Weight 41 kg.

Description

The top section is made up of the following elements:

- 1°) A hot-galvanised steel tube height 226.5 cm (diam. 6 cm) for the coupling on the posts with 12.7 cm of diameter; it is provided of a flange (A - diam. 7.5 cm - thickness 0.5 cm) and a hole (diam. 2 cm) for the passage of power supply cable.
- 2°) Cast iron junction cast in a single piece, height 17.5 cm, with two rings (diam. 16.8 cm), surmounted by a tapered section.
- 3°) A ring in hot-galvanised steel for lower support of the suspension bracket. It is secured to the supporting tube (1°) with two M8 stainless steel grubs.
- 4°) A ring in hot-galvanised steel for upper support of the suspension bracket. The ring has a hole (B - diam. cm 1,8) for the passage of power supply cable. It is secured to the supporting tube (1°) with two M8 stainless steel grubs.
- 5°) A suspension bracket height 155 cm, with a protrusion of 93 cm. Structurally the bracket is composed of a tube in steel (diam. 4,2 cm.) and support attachments (C) in spheroidal cast iron. The entire assembly is hot-galvanised. The suspension bracket is fixed to the support rings 3° - 4° with four screws M8 in stainless steel. The suspension bracket has at his end an internal thread 3/4" GAS for attaching the light fixture (D). The power cables pass inside the suspension bracket (F).
- 6°) A cast iron finial (height 20 cm, lower diam. 11 cm) decorated with two tori and a sphere. The finial is fitted onto element (1°) and is secured with an M8 stainless steel screw (E).
- 7°) Two decorative elements in cast iron. Each element is secured with two M8 stainless steel screws to support rings (3°) and (4°).

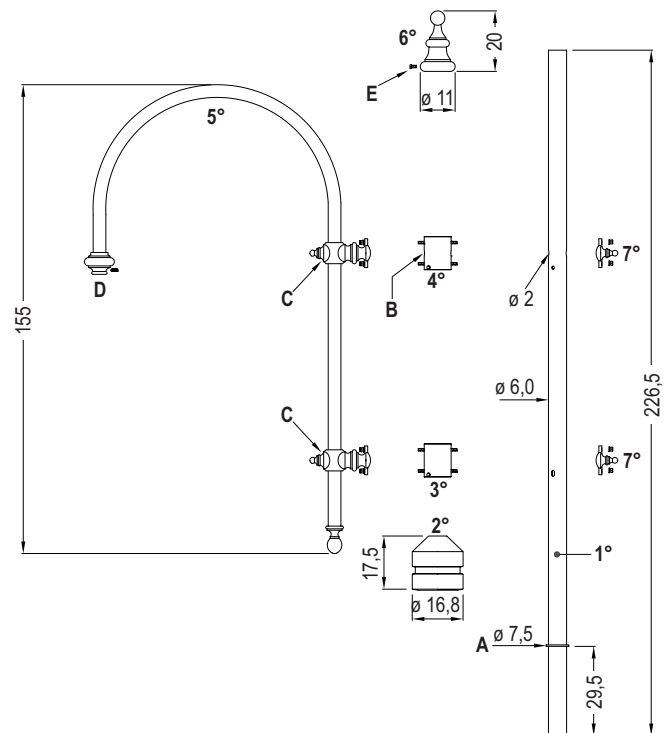

Exploded

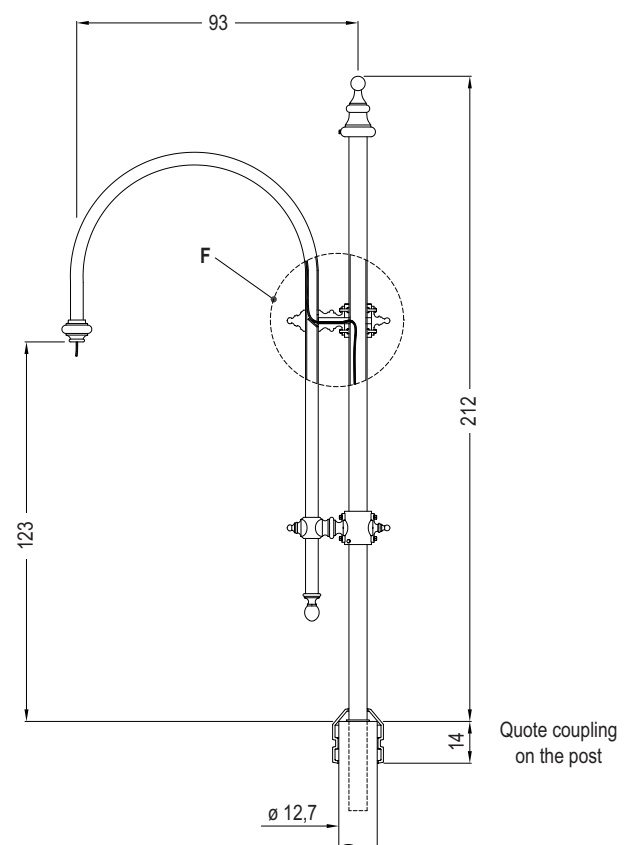

Section - Elevation view