

Project location:			
Project name:			
Model #:	4102.129.007	Date	

Description

Intermediate top section formed by S235J UNI EN 10219-1 steel elements
hot-galvanized to UNI EN ISO 1461 standards, all complying in shape, measurements and various decorations to the drawing that is an integral part of the project.

The top section includes the following parts:

- 1°) A bracket 34 3/4" long (diam. 3") welded to the central tube, height 6 3/4" (diam. 4 2/4") to be inserted on the post core, supplied with stainless steel screws for fixing (C). The end bracket has a closing plastic plug (A).
- 2°) A tube 27 2/4" long (diam. 1 3/4") for the light fixture support, secured to the the bracket (1°) by a half-collar (B) and two M8 stainless steel passing screws (D); at the outer end it has a 3/4" GAS junction for the light fixture connection.

The total height of the top section is 30 2/4", the projection is of 31 2/4".

Protection of surfaces

Please refer to the specification on painting procedures of the materials.

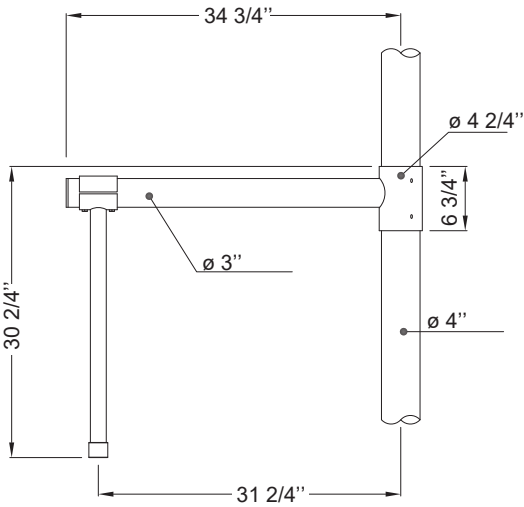

Elevation

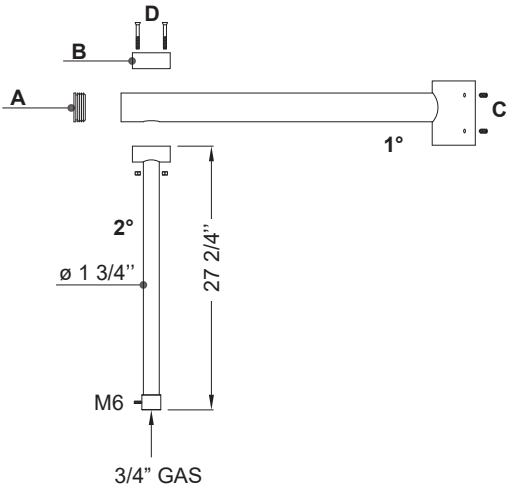

Exploded