

Project location:			
Project name:			
Model #:	4100.122.601	Date	

Fixture type:	

Contemporary > Mizar Top 4100.122.601

TECHNICAL DATA:

Dimension - Weight - EPA:

Height (effective)	Projection	Width	Lenght	Weight	EPA
29.13"	27.56"	5.70"	36.22"	72.20 lb	3.90 ft²

Materials:

- Steel UNI EN 10219-1 (S235JR), hot galvanized UNI EN ISO 1461 standard.
- Cast iron UNI EN 1561.
- Screws and bolts in stainless steel.

Description

- A ring (1) in hot galvanized steel (diam. 5.12"; high 4.33") for fixing the arm (5) to the post (A) with screws M8.
 - A support element (2) in cast iron (diam. 5.70"; height 14.76") inserted on the post for 9.00" and fixed with six screws (C) M10.
 - A closing cap element (3) in cast iron, fixed to the element (2) with a screw (F) and a plate inserted inside to the element (2).
 - A rectangular tubular element (4) in hot galvanized steel, fixed to element (2) with screws (E) M10.
 - An arm (5) composed by a rectangular tubular (section 4.72" X 1.57") and a curved tube (diam. 1.3") welded together, fixed to the ring (1) and element (2) with screws (B, C).
 - A terminal element (6) in cast iron (diam. 4.13"; height 9.45"), inserted at the end of arm and fixed with a screw (G) M8. The element is equipped with a connection threaded G3/4" for fixing the suspended light fixture.
- Electric cable pass inside to arm as shown in the drawing.

Fixing

- Assembling all elements of the top (included the electrical cable into just measure to connect at the terminal board at the base of post).
- Inserting the top on the pole, orienting the arm and tighten the six screws (C) and the two screws M8 on the lower ring (1).

Finish:

- Standard colour is dark grey NERI type.
- Information about paint steps used on this product in specific technical sheet.

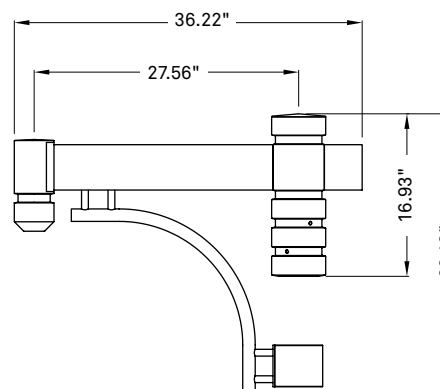

Side view

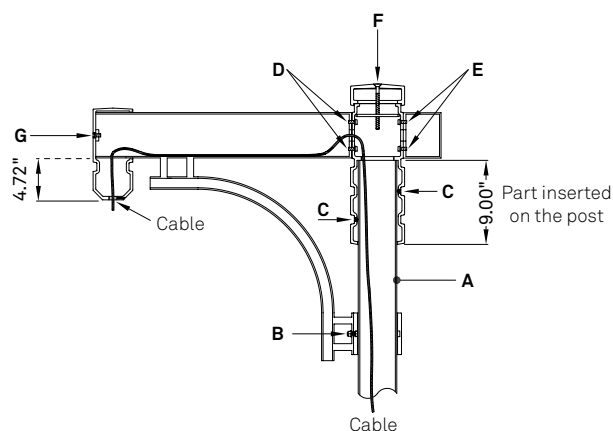

Section

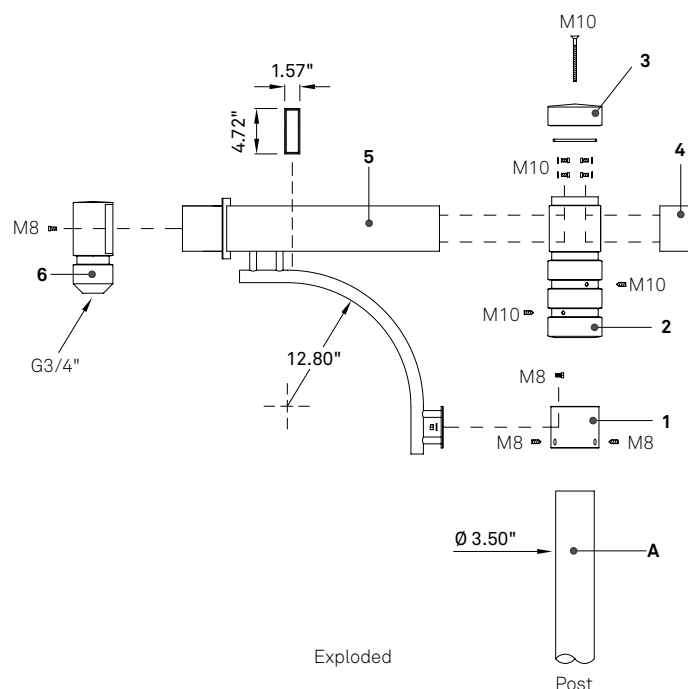

Exploded