

Project location:			
Project name:			
Model #:	4105.190.500	Date	

DESCRIPTION

Predisposition

- Outside insertion on tube diam. 3 2/4”(A).
- A lateral curved arm (Ø 2 1/4”).
- Free orientation of arm.

Materials

- Steel tubes UNI EN 10219-1, S235JR, hot galvanized as UNI EN ISO 1461 norm.
- Plastic material.
- Screws in stainless steel.

Structural elements

- Top composed with tubes in hot galvanized steel welded together.
- Vertical tube (Ø 4”), equipped with three M10 screws (B) disposed at 120° for fastening (19 3/4”) on pole terminal Ø 3 2/4” and closing caps (C) in plastic material.
- Curved support arm (D - Ø 2 1/4”), welded to the vertical tube, provided with a coupling (E) for suspended luminaires, with thread female G3/4 "and closing caps (F) of plastic material. The power cable (max. Ø 2/4”) passes inside of arm.
- Tie-rod (G) (Ø 3/4”), welded to the vertical tube and to the curved arm.

Dimensions and weight

- Height max: 4’ 3 2/4”(to be added to pole).
- Height of light point connection: 35”
- Arm projection: 3’ 11 1/4”.
- Weight max: 37.47 lb.

Painting

- Standard color is dark matt gray, type Neri.
- Information about paint steps used on this product in specific technical sheet.

DRAWING

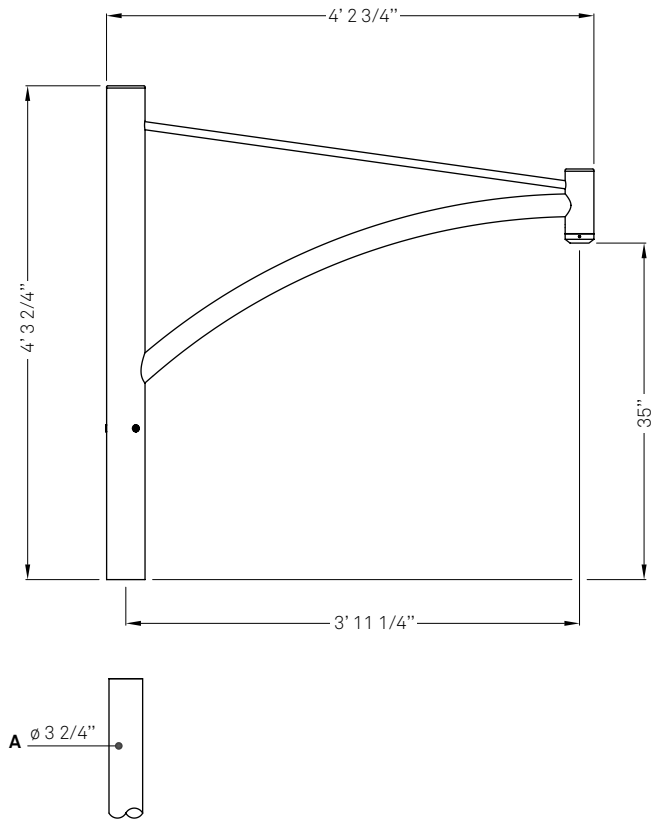

Side view

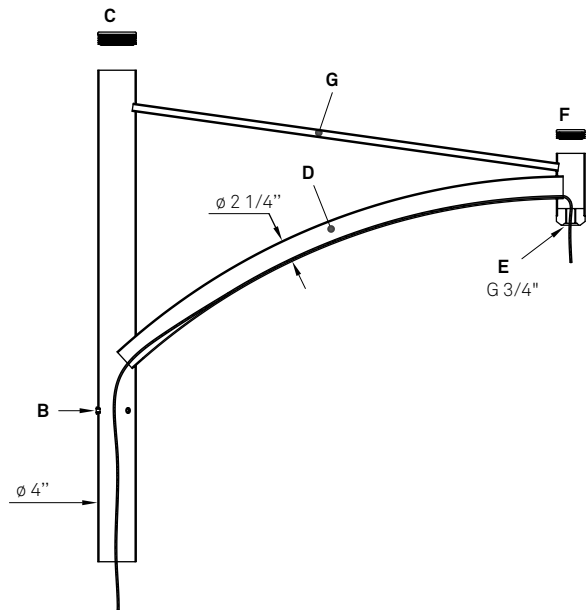

Section