

Project location:			
Project name:			
Model #:	4023.000	Date	

Description

Wall bracket in UNI EN 1561 cast iron, corresponding in shape, size and ornamentation to the diagrams, which are an integral part of the specifications.

The wall bracket is composed as follows:

1°) A cast iron bracket with wall plate cast in a single piece and decorated as shown in the diagram. Ornamentation is composed of a wall plate (A – height 16 1/4", width 6") with three holes (diam. 2/4") for fixing to the wall with expansion bolts, a collar (h) with two horizontal flutes, a large volute (g) rising upwards from the centre of the wall plate, nine leaves, of which three terminate in volutes (a), two are double (c) and four are normal (b, d, e), a central fruit motif (f) and a cymatium at the outer extremity (D – diam. 2 3/4"). The bracket is provided with a 3/4" GAS threaded tube with nut and rose in stainless steel for attaching the light fixture (C) and an internal tube for the passage of a power cable. The power cable enters the wall bracket at point B.

The total height of the wall bracket is 19 3/4", with a projection of 19 1/4".

Protection of surfaces

Please refer to the specification on painting procedures of the materials.

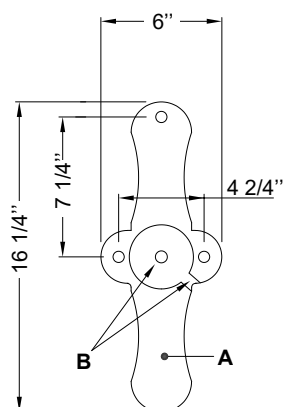

Rear view of the plate

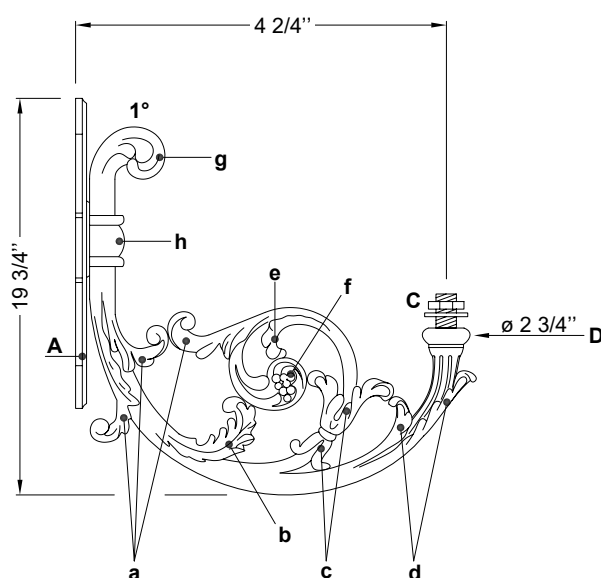

Side view