

|                   |      |
|-------------------|------|
| Project location: |      |
| Project name:     |      |
| Model #:          | Date |

|               |
|---------------|
| Fixture type: |
|               |

## 4066.000

### WALL BRACKET

#### Upright connection

#### Heritage

EPA = 1.076 ft²

Weight = 34.41 lb (10.5 Kg)

Height = 17.70"

Length = 39.40"

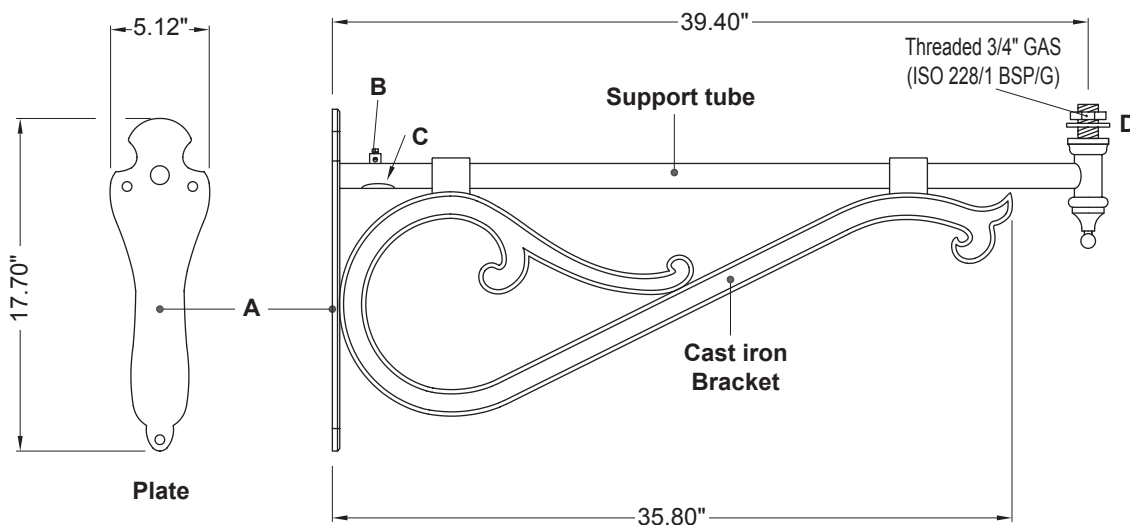

### SPECIFICATIONS:

#### Construction:

- A steel support tube (diam. 1.3", length 36.4") hot-galvanized. At the outer extremity the tube has a junction (D) welded for attaching the light fixture. Externally this junction has a thread for attaching the light fixture. The underside of junction is composed by an element decorated. The support tube has a slot (C) for introduce from external a power cable into the interior, and an earthing terminal (B).
- A cast iron bracket with wall plate (height 17.7" - projection 35.8") cast in a single piece, decorated as shown in the diagram.

The bracket and the support tube are joined by two collars cast together with the bracket.

Support plate (A) height 17.7"; width 5.12" provided with three holes (diam. 0.51") for fixing to the wall with expansion bolts, welded together the support tube.

From the wall, a power cable can be introduced by the hole (E - diam. 1.06") on the plate, into the support tube.

#### Materials:

- Support tube in steel (UNI EN 10219-1), hot-galvanized (UNI EN ISO 1461).
- Bracket in cast iron (UNI EN 1561).
- Stainless steel screws.

#### Mounting:

- Plate predisposed for fixing to wall with three anchor bolt.

#### Finish:

- Standard colour is dark grey NERI type.
- Information about paint steps used on this product in specific technical sheet.

#### Operation and maintenance:

- Control every year the state of surfaces. If necessary repairing the damaged part with original varnish.

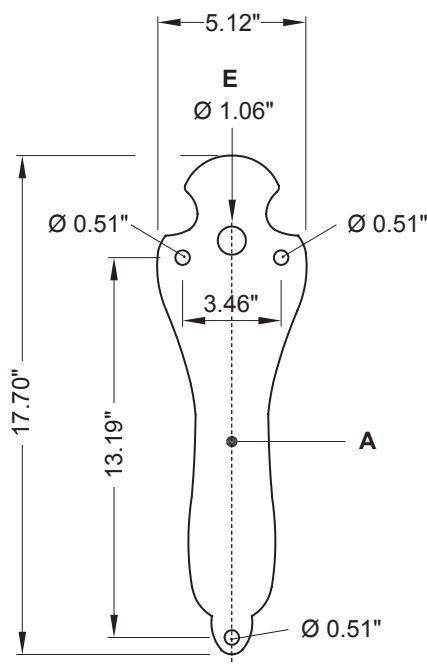

Plate details